

「JR-SHIKOKU_Station_Wi-Fi」 Connection Guide

Ver1.0

June, 2018

Procedure to connect JR-SHIKOKU_Station_Wi-Fi

【Wireless LAN info】

- **SSID : JR-SHIKOKU_Station_Wi-Fi**
- **IP Address: Acquired automatically**
- **DNS Address : Acquired Automatically**
- **Encryption : None**

Note :

The device need to turn acquire IP address and DNS address automatically on.
If IP address or DNS address are already set, it is recommended that you make note of the settings.

System requirements

- ① **Android (Android 4.0 or later)**
- ② **iPhone/iPod touch/iPad (iOS 5.0 or later)**
- ③ **Windows (Windows 7 or later)**
- ④ **Mac (Mac OS X or later)**

Note:

To use this service, the device must be set to enable JavaScript and Cookies.



【Android】 Procedure to connect (e.g.: Xperia)

- ① Tap the "Application" icon.
- ② Tap the "Settings" icon.
- ③ Tap "Wi-Fi".
- ④ A list of Wi-Fi networks will appear. Select "JR-SHIKOKU_Station_Wi-Fi".

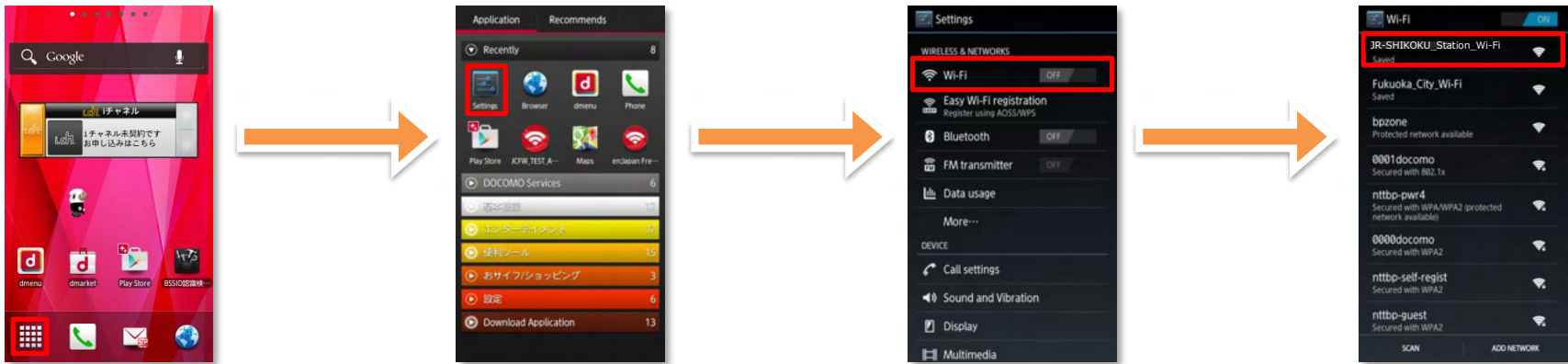

- ⑤ Tap "Connect".
- ⑥ Return to the home screen and tap "Browser".
- ⑦ When the screen below appears, connection is complete.



To the User Entry page. (P.6)

[iOS] Procedure to connect (e.g.: iOS 8.0)

① Tap the "Settings" icon.

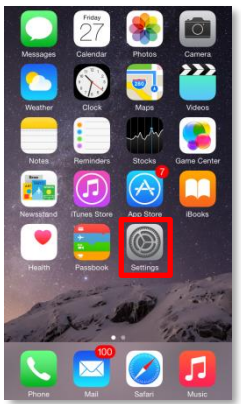

② Tap "Wi-Fi".



③ Tap the button to slide from "Off" to "On".

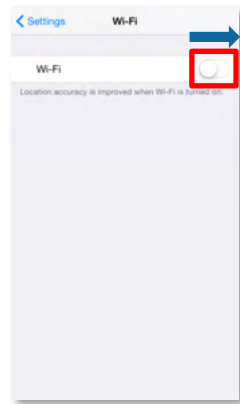

④ A list of Wi-Fi networks will appear. Select "JR-SHIKOKU_Station_Wi-Fi".

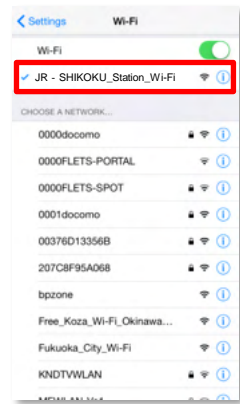

⑥ When the screen below appears, connection is complete.



To the User Entry page. (P.6)

【Windows】 Procedure to connect (e.g. : Windows7)

① Click on the network icon in the lower right corner of the screen

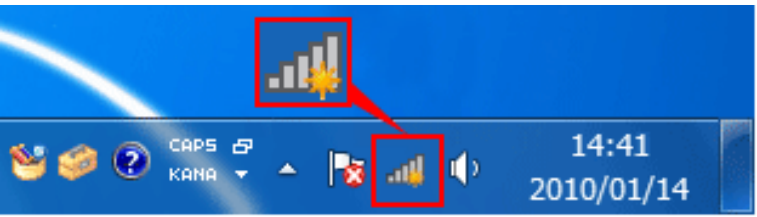

② Select "JR-SHIKOKU_Station_Wi-Fi", and click "Connect".



③ When the connection work is complete, the icon will be displayed as follows.

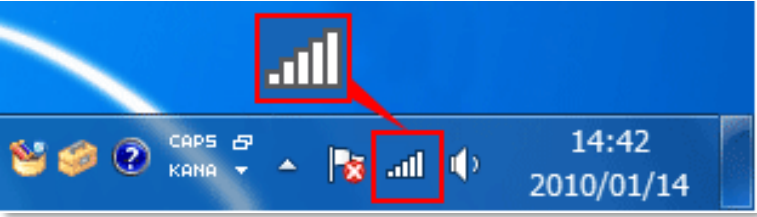

⑤ When the screen below appears, connection is complete.

④ launch the Browser (Internet Explorer or Google Chrome) .



To the User Entry page. (P.6)

[Mac] Procedure to connect (e.g. : Mac OS X)

① Select "Turn Wi-Fi On" from the Wi-Fi menu in the upper right corner of the screen.



② Select "JR-SHIKOKU_Station_Wi-Fi" from the displayed networks.

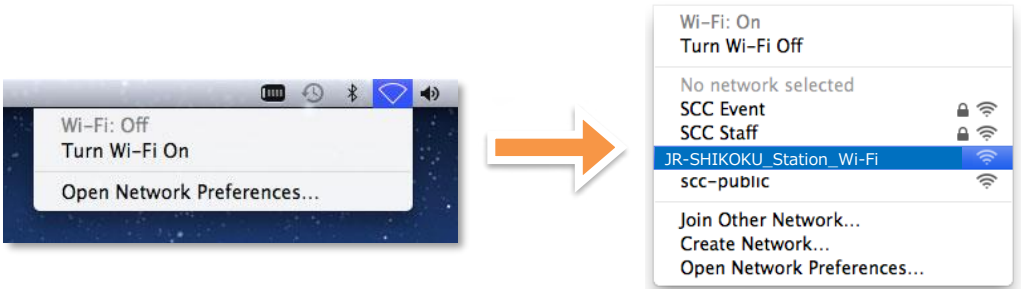

③ launch the Browser (Safari or another browser).



⑤ When the screen below appears, connection is complete.



User Entry Process (When Using a Smartphone)

Choose "JR-SHIKOKU_Station_Wi-Fi"

① When the screen below appears, connection is complete

② Tap "Using your e-mail address".

③ Enter your e-mail address, Then tap "Confirm"

④ Once you have checked the security information, tap "I agree"

⑤ Temporary completing registration

⑥ Registration mail reception

⑦ You are now Connected to the internet

It is redirected to a home page of designation

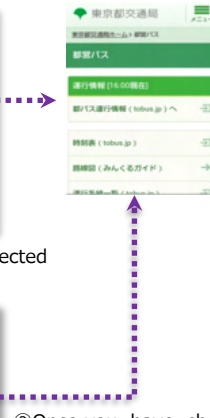
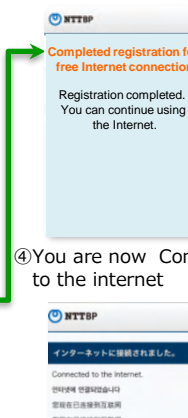
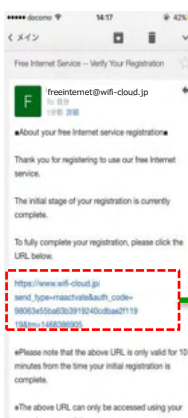
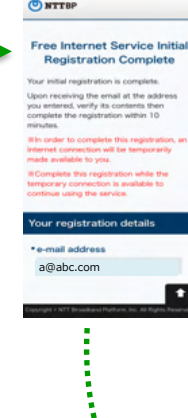
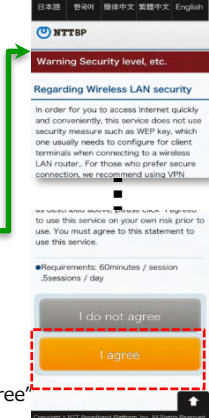
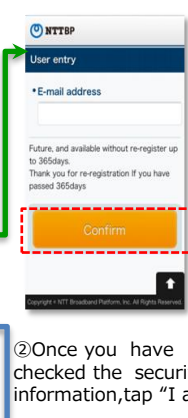

First time use

At the time of a connection frequency excess.

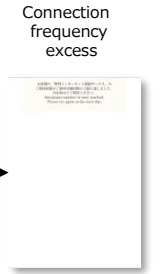

Connection frequency excess

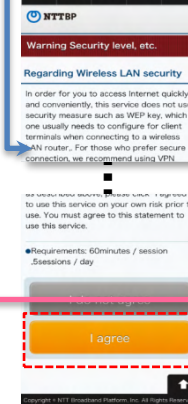

③ Insert SNS Account

Mail Transmission ※The internet is available for free of charge for 10 minutes

It's connected more than 2nd time, frequency upper limit sheep rise

④ You are now Connected to the internet

② Once you have checked the security information, tap "I agree"

Important Notes

- This service is operated by NTT Broadband Platform, Inc (NTTBP) .
- This service is provided on a best-effort basis. Therefore, connection speeds and quality cannot be guaranteed.
- Please understand that no WEP key or other encryption is set. Security is the responsibility of the user.
- You must enter your e-mail address on the entry page.
 - * Registration is not required after the second login.
- After registering user information, the user is automatically logged into the internet. Connection is provided for 15 minutes. After 15 minutes have passed, the user will be required to log in again from the security notice page.
- The service is available up to 3 times per day.
- VPN and some other services may not be accessible due to the design of the network.
- No devices or software used by customers of this service are supported by NTTBP. Please contact the device or software manufacturer for support.
- Please be aware that NTTBP shall assume no responsibility whatsoever in the event of any personal damage to the user or dispute with a third party resulting from use of this service.
- Service may be temporarily unavailable due to equipment maintenance or other reasons.
- If a user's device has been configured with some domain filters or spam filters, this registration e-mail may not be able to get through to the recipient successfully.
- NTTBP takes no responsibility for losses or damages that come from being unable to use an API provided by a third party due to failures or malfunctions, etc.
- The URL stated in this registration email will be valid for 10 minutes from when the email is sent.
- When using an SNS account, the API of the respective SNS company will be used.
- You may connect to the Internet for 10 minutes only in order to receive your registration email. The Internet connection will be available without user registration during this time only, and you will be transferred to the portal screen after 10 minutes.
- The URL stated in this registration email will be valid for 10 minutes from when the email is sent.
- NTTBP will not acquire any personal information tied to your social networking accounts, unless specified by a separate contract with the area owner.
- In terms of the second connection onward, you will need to do authentication based on the MAC address linked to each device. Hence, if you want to use the free Internet connection service within the same area from a different device, you will need to register each device even if you have already registered with the same e-mail address.

* Microsoft, Windows, and the Windows logo are trademarks or registered trademarks of Microsoft Corporation in the United States and other countries.

* Other product names and logos are trademarks or registered trademarks of their respective manufacturers.

* ™ and ® symbols are not displayed near the trademarks or registered trademarks in this document.